

chiron

CNC Machining Centres



Datasheet

WM 02

high speed

ISO 40

Tools 6/12

Chip-to-chip 1.9 s

Spindle speed up to 12 000 rpm

Rapid 60 m/min

Acceleration 0.5 g

**Seconds
ahead**

CHIRON-WERKE GmbH & Co. KG

Talstraße 23
 D-78532 Tuttlingen
 Telephone (0 74 61) 9 40-0
 Telefax (0 74 61) 31 59
 info@chiron-werke.de
 www.chiron-werke.de



**WM 02
 high speed**

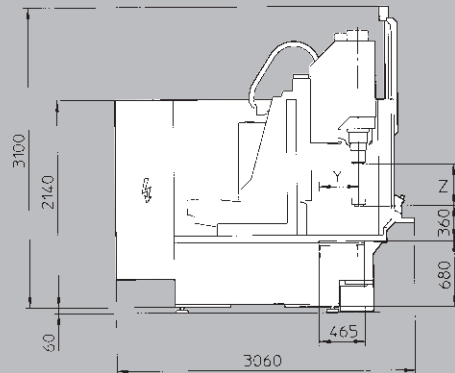
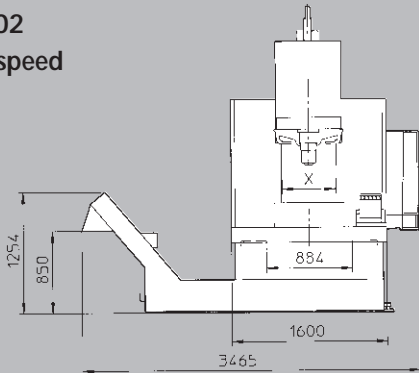

Technical data

Drilling capacity in ST 60 with HM drill	42 mm
Tapping	M 30
Milling capacity in ST 60	300 cm ³ /min
Tool storage capacity	6
Tool taper ISO 7388	ISO 40
Max. tool diameter	65 mm
If adjacent places are free	150 mm
Max. tool weight	2.5 (5) kg
Tool change time	approx. 0.9 s
Chip-to-chip time	approx. 1.9 s
Spindle drive, AC	18 KW
Infinitely variable speed range	20 - 12 000 min ⁻¹
Max. torque	140 Nm
Diameter front spindle bearing	70 mm
Tool clamping force	8 000 N
Distance spindle to column	435 mm
Distance spindle nose to table surface	330 - 55 mm
Travel X-axis	550 mm
Travel Y-axis	470 mm
Feed force X-axis, Y-axis	5 000 N
Travel Z-axis	425 mm
Feed force Z-axis	10 000 N
Rapid feed rate	60 m/min
2 clamping surfaces with dowel holes	
Table load	500 kg
Chip conveyor, discharge height	850 mm
Coolant device, container capacity	500 ml
Automatic doors	
Renishaw probe	LP2H
Total connected power	approx. 15 KVA
Machine weight	approx. 4.0 t
Floor space	approx. 5.3 m ²
Air connection	6 bar

Options

■ **Pneumatic actuated wheel fixture designed for quick change over 13"-20" (new)**

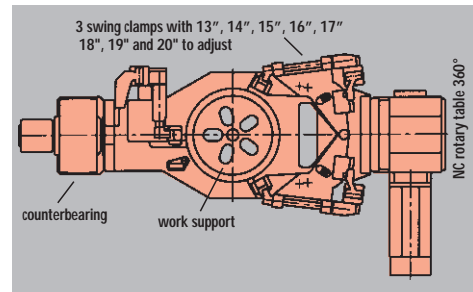

■ **Chip conveyor with high pressure 20/70 bar**

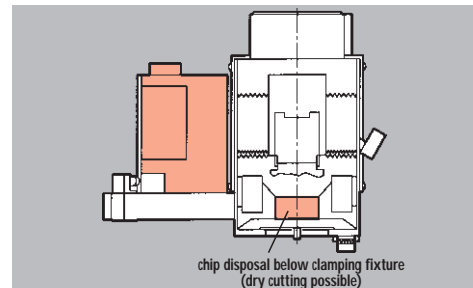

Tool storage capacity	12
High speed plus-Type	
Speed range	20 - 20 000 rpm
Rapid traverse rate	60 m/min
Acceleration	1 g

- Full enclosure ■ Extraction ■ Through the spindle coolant up to 70 bar
- Process monitoring ■ Tool measurement and management ■ Drill fracture control, tool life management ■ Chiron-laser-control ■ Direct path measuring system
- Dry machining with minimal lubrication ■ Tool taper HSK-A63 ■ Multi-spindle head adaptor