

# chiron

## CNC Machining Centres

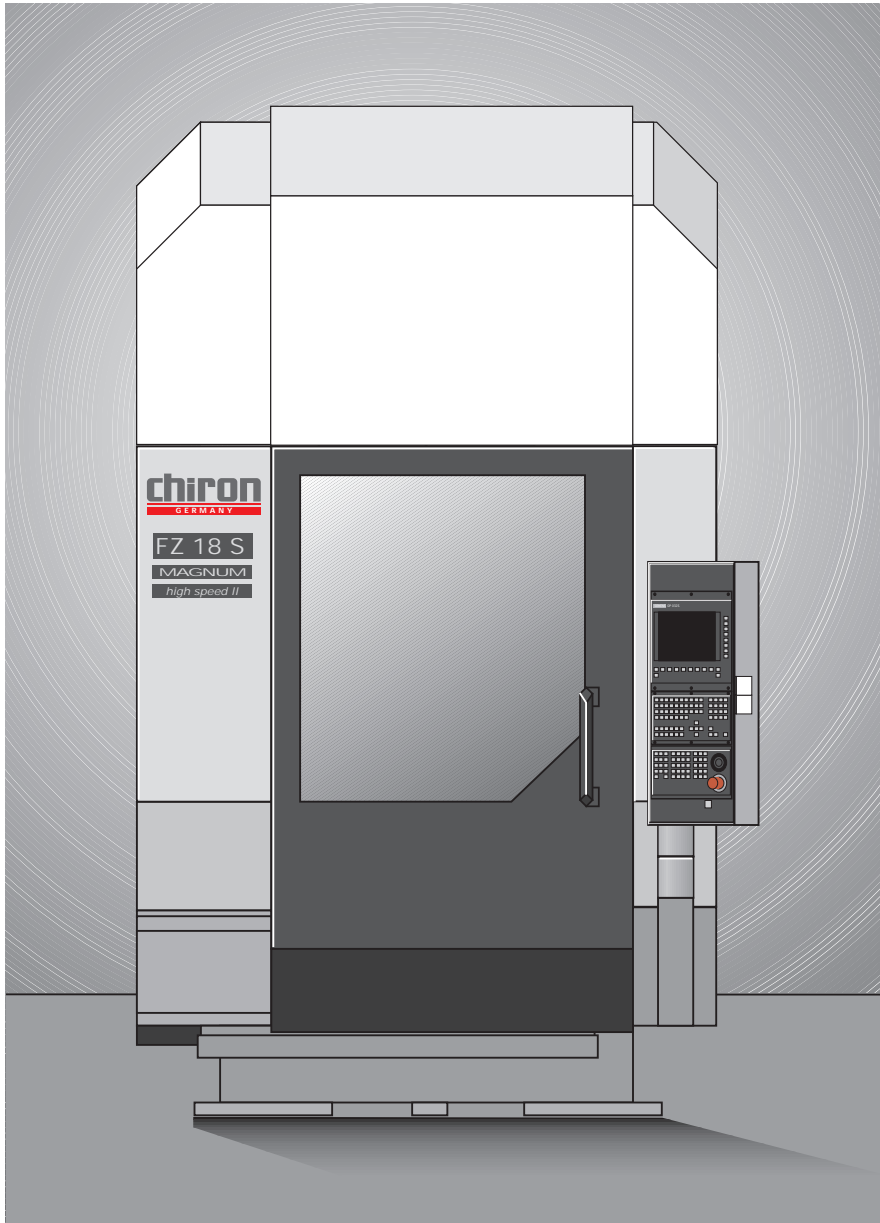

### Datasheet

**FZ 18 S Magnum**

**high speed II**

15 000 rpm in approx. 1.0 s

40 m/min in 0.16 s

Through tool coolant up to 70 bar

Deep hole drilling 30 x dia.

without peck drilling

### Seconds ahead

## FZ 18 S Magnum high speed II

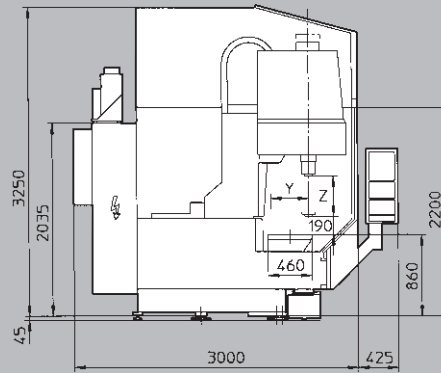
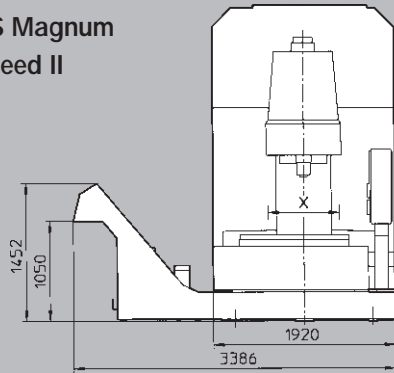

### Technical data

Drilling capacity in ST 60 with HM drill	36 mm	
Tapping	M 24	
Milling capacity in ST 60	250 cm <sup>3</sup> / min	
Tool storage capacity	20	36
Tool taper ISO 7388	ISO 40	ISO 40
Max. tool diameter	65 mm	75 mm
If adjacent places are free	180 mm	105 mm
Max. tool weight	5 (8) kg	8 (12) kg
Tool change time	approx. 0.9 s	approx. 1.5 s
Chip-to-chip time	approx. 2.4 s	approx. 2.9 s
Spindle drive	14 kW	
Infinitely variable speed range	20 - 15000 min <sup>-1</sup>	
Max. torque	90 Nm	
Diameter front spindle bearing	65 mm	
Tool clamping	mechanically locked	
Distance spindle to column	435 mm	415 mm
Distance spindle nose to table surface	190 - 615 mm	
Travel X-axis	750 mm	
Travel Y-axis	400 mm	
Feed force X-axis, Y-axis	8000 N	
Travel Z-axis	425 mm	
Feed force Z-axis	10000 N	
Rapid feed rate	40 m / min	
Fixed table clamping surface	1150 x 460 mm <sup>2</sup>	
T-slots	2 x 18 H 12	
Reference slot	18 H 8	
Table load	1200 kg	
Coolant through spindle	70 bar	
Chip conveyor, discharge height	1050 mm	
Coolant device, container capacity	500 l	
Full enclosure	illuminated	
Thermocontrol		
Total connected power	approx. 30 kVA	
Machine weight	approx. 8 t	
Floor space	approx. 6.7 m <sup>2</sup>	
Air connection	6 bar	

### Options

- Tool taper  
HSK-A 63  
DIN 69893

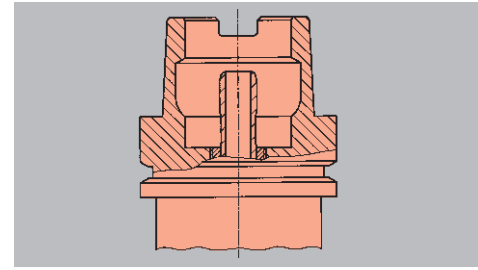

- 2-axes  
NC rotary table

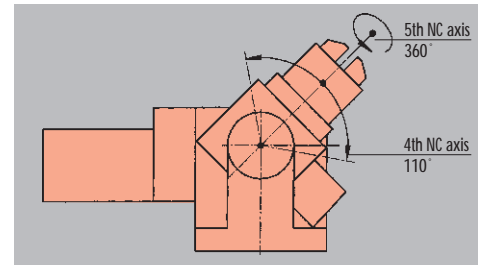

### Extraction for full enclosure

Multi spindle head adaptor max. dia.	180 mm	160 mm
Max. weight	8 kg	12 kg
Travel z-axis	630 mm	

- Automatic door
- Workpiece transport and hopper equipment
- Probe, tool measurement and management
- Drill fracture control and tool life management
- Chiron-laser-control
- Direct path measuring system