

chiron

CNC Machining Centres

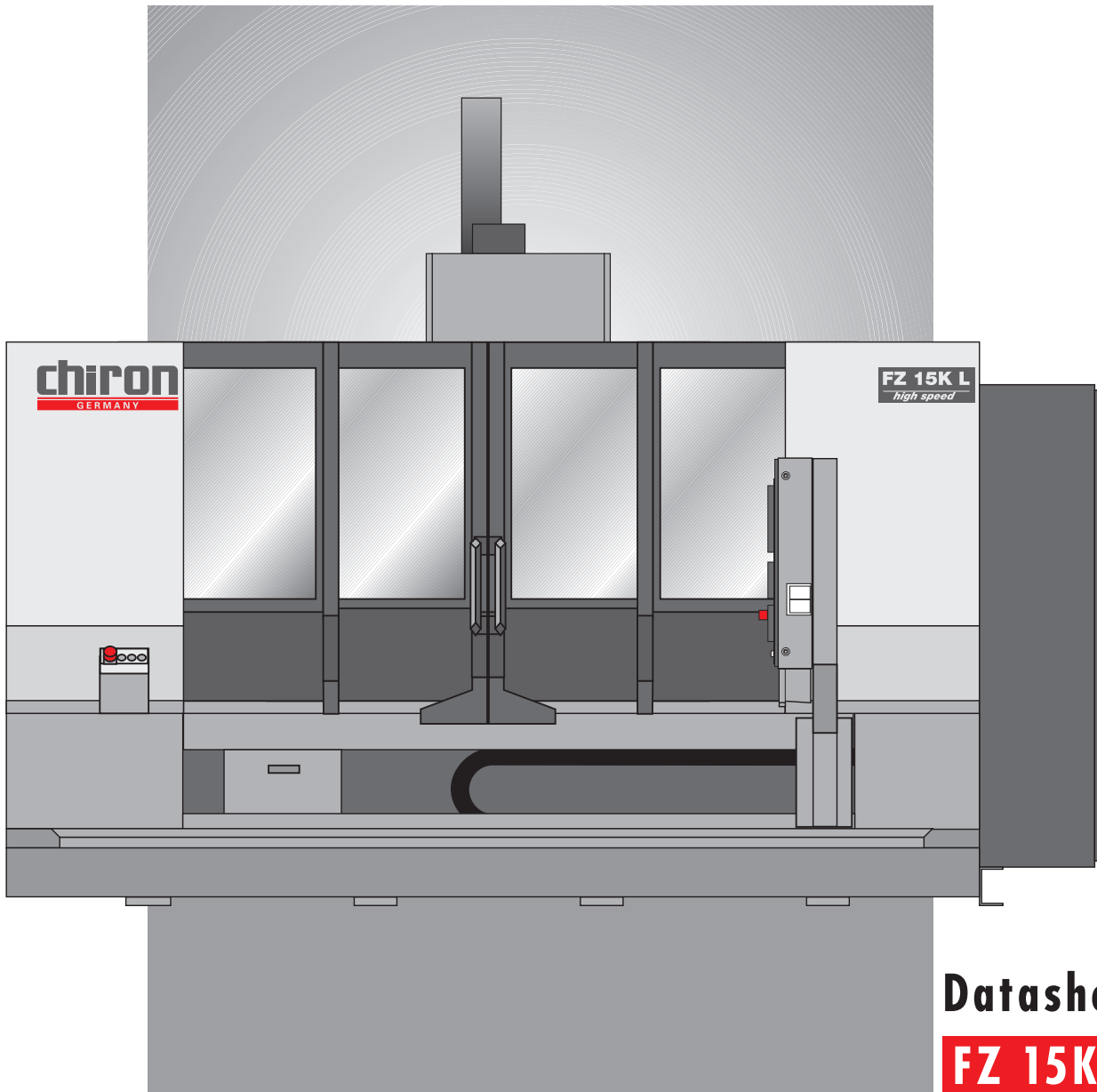

Datasheet

FZ 15K L

HSK-A 63

Tools 48

Chip-to-chip 2.4 s

Spindle speed up to 20 000 rpm

Rapid up to 60 m/min

Acceleration up to 1.2 g

**Seconds
ahead**

CHIRON - WERKE GmbH & Co. KG

Talstr. 23 · D-78532 Tuttlingen
 Telephone (0 74 61) 9 40-0
 Telefax (0 74 61) 31 59
 info@chiron-werke.de
 www.chiron-werke.de



FZ 15K L

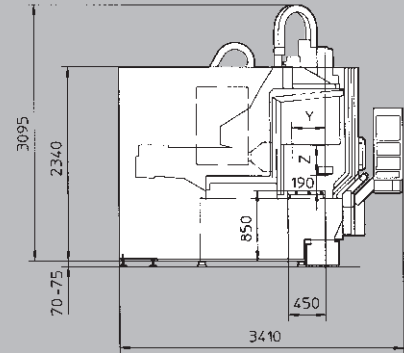
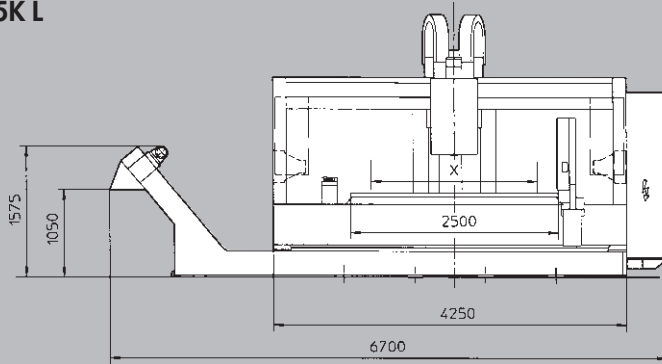

Technical data

Drilling capacity in ST 60 with HM drill	42 mm
Tapping	M 30
Milling capacity in ST 60	500 cm ³ /min
Tool storage capacity	48
Tool taper DIN 69893	HSK-A 63
Max. tool diameter	80 mm
If adjacent places are free	125 mm
Max. tool weight	10 kg
Tool change time	approx. 0.9 s
Chip-to-chip time	2.4 s
Spindle drive	28 KW
Infinitely variable speed range	20 - 12 000 rpm
Max. torque	180 Nm
Diameter front spindle bearing	65 mm
Tool clamping	mechanically locked
Distance spindle to column	90 - 495 mm
Distance spindle nose to table surface	190 - 550 mm
Travel X-axis	1 250 / 2 000 / 2 600 mm
Fixed table length	1 850 / 2 600 / 3 200 mm
Max. shuttle operation	--- / 2 x 750 / 2 x 1 050 mm
Travel Y-axis	400 mm
Fixed table width	450 mm
Feed force X-axis, Y-axis	5 000 N
Travel Z-axis	360 mm
Feed force Z-axis	10 000 N
Rapid feed rate	60 m/min
Acceleration X-axis	0.5 g
Acceleration Y-axis	1.0 g
Acceleration Z-axis	1.2 g
T-Slots	2 x 18 H 12
Reference slot	18 H 8
Chip conveyor, discharge height	1 050 mm
Coolant device, container capacity	600 l
Total connected power	approx. 20 kVA
Machine weight	6.5/7.5/8.5 t
Floor space	9.6/14/17.5 m ²
Air connection	6 bar

Options

- NC rotary table
- NC rotary table with basic fixture
- Through the spindle coolant up to 70 bar
- Full enclosure with extraction
- Automatic doors
- Dry machining with minimal lubrication
- Thermocontrol
- Probes for workpiece and tool measurement
- Tool breakage monitoring and tool life management
- Direct path measuring system
- Multi-spindle head adaptor
- Workpiece transport and magazine equipment
- Stationary 3-D probe system

■ 4-spindle NC rotary table

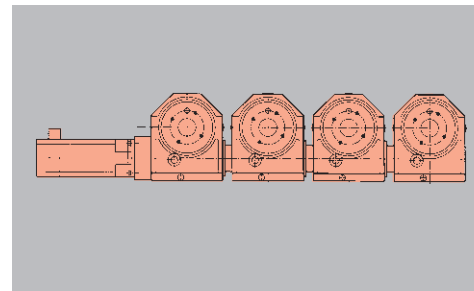

■ Chiron-laser-control

